



Sep 2008
Global Marketing Group

1. Top Menu



TOPCON LASER SCANNER
Version 1.03
WARMING UP NOW

TOPCON LASER SCANNER
PROJECT: PROJECT1
STATION: STATION1

SELECT MENU ¥
F1 STATION MENU
F2 SCAN MENU
P1/2 ↓

Press  to turn on power

The keys start to flash in orange, and the calibration begins.

Just before the calibration ends, the current project name and station name appear.

The main menu appears when the calibration finishes.

2. Tilt setting and Zoom Control

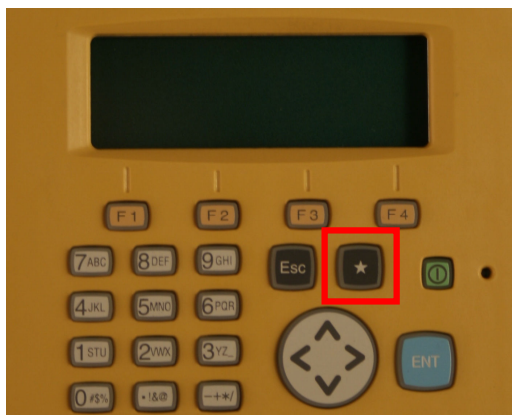

Press  (star key)

F1 TILT [OFF]
F2 ZOOM CONTROL[NOR]
P1/3 ↓

F1

The method to correct tilt

Press F1 key

TILT SETTING [OFF] ¥
ON OFF

F1

Press F1 key to turn on the tilt correction

TILT SETTING [ON] ¥
X :+0°01'02"
Y :-0°04'05"
ON OFF

ESC

Level the GLS-1000

After leveling, press F4 key to set the tilt correction "ON"

F1 TILT [ON]
F2 ZOOM CONTROL[NOR]
P1/3 ↓

F2

The method to set the zoom control to set the beam aperture

ZOOM CONTROL ¥
SELECT DISTANCE
F1 UNDER 50M
F2 OVER 50M

F1 or F2

Press F1 key when the distance to the object is less than 50m, and press F2 when the distance is more than 50m

3D SCANNING ¥
OVER 50M [NOR]
F1 FAST F2 NORMAL
F3 DETAIL

F1 or F2 or F3

to select the scanning mode

F1 TILT [ON]
F2 ZOOM CONTROL[NOR]
P1/3 ↓

F4

Press F4 to set the mode

SELECT MENU ¥
F1 STATION MENU
F2 SCAN MENU
P1/2 ↓

ESC

Press ESC key to return to the menu

3. Create a project

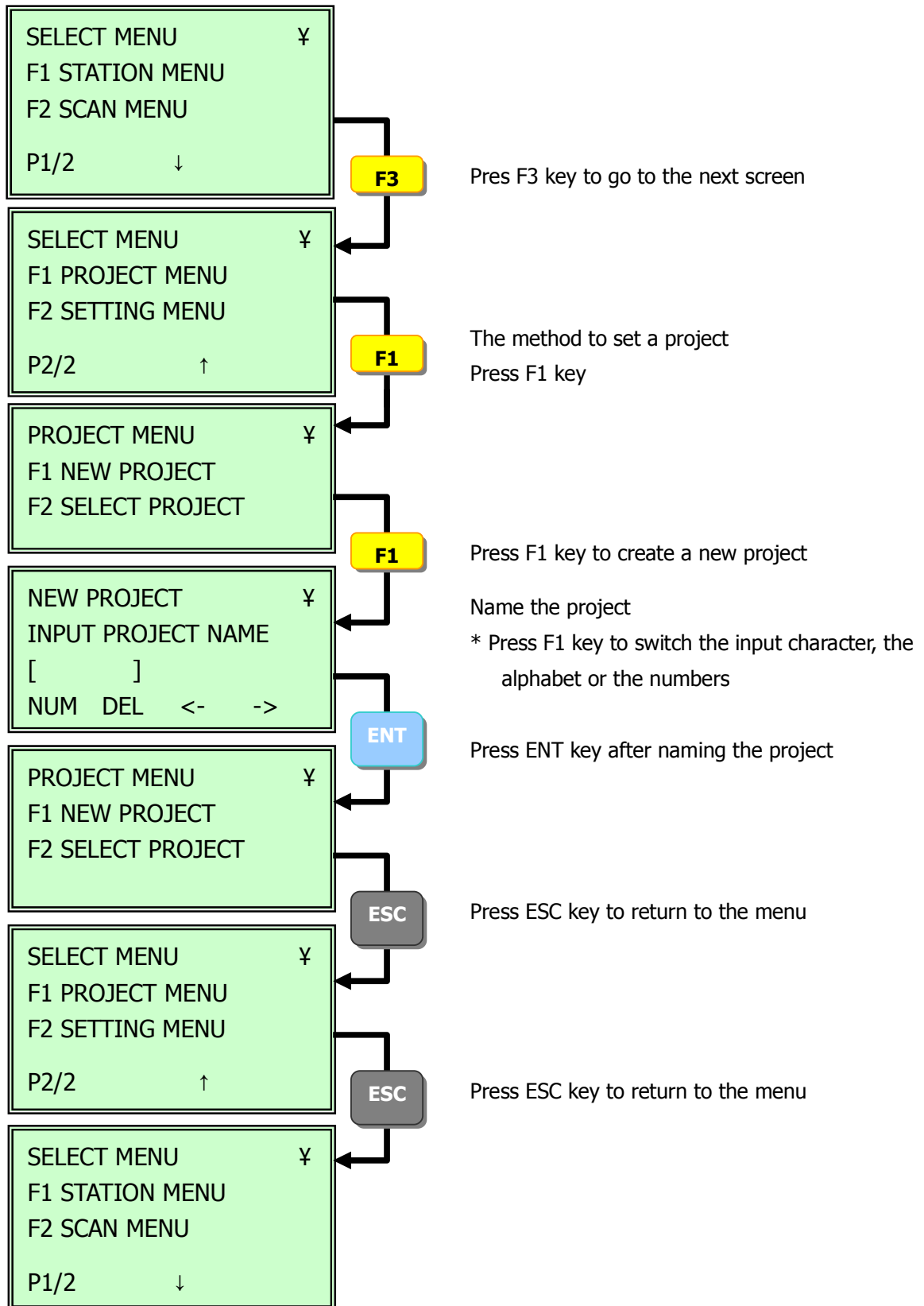

4. Create a station

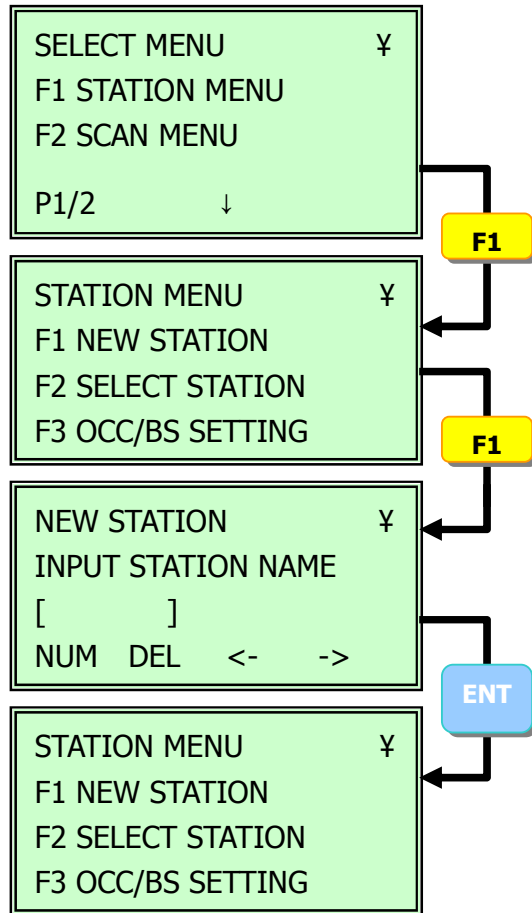

Press F1 key to set the station (scan position)

Press F1 key to create a new station

Name the station

* Press F1 key to switch the input character, the alphabet or the numbers

Press ENT key after naming the station

* The station will not be changed when you use the same scan position. Create a new station when you move the scan position.

4. Target Scan

4-1.Target Scan by the OCC/BS Method

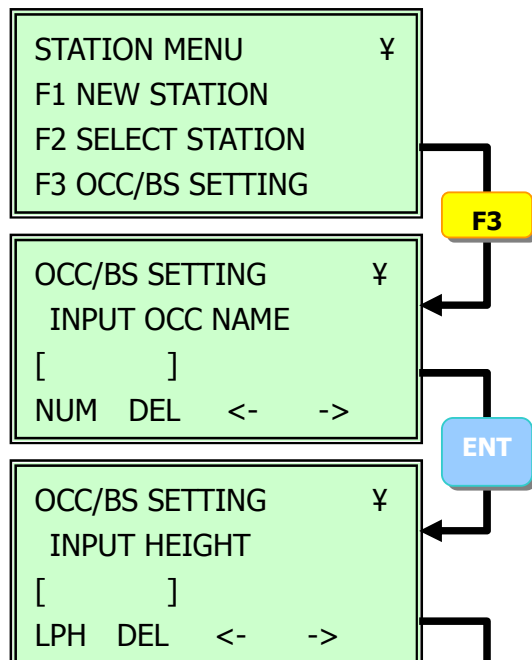

Do the orientation of the OCC/BS method

Press F3 key

Name the OCC

* Press F1 key to switch the input character, the alphabet or the numbers

Press ENT key

Measure and input the height

*Measure up to this mark —○— between the two shuttles.

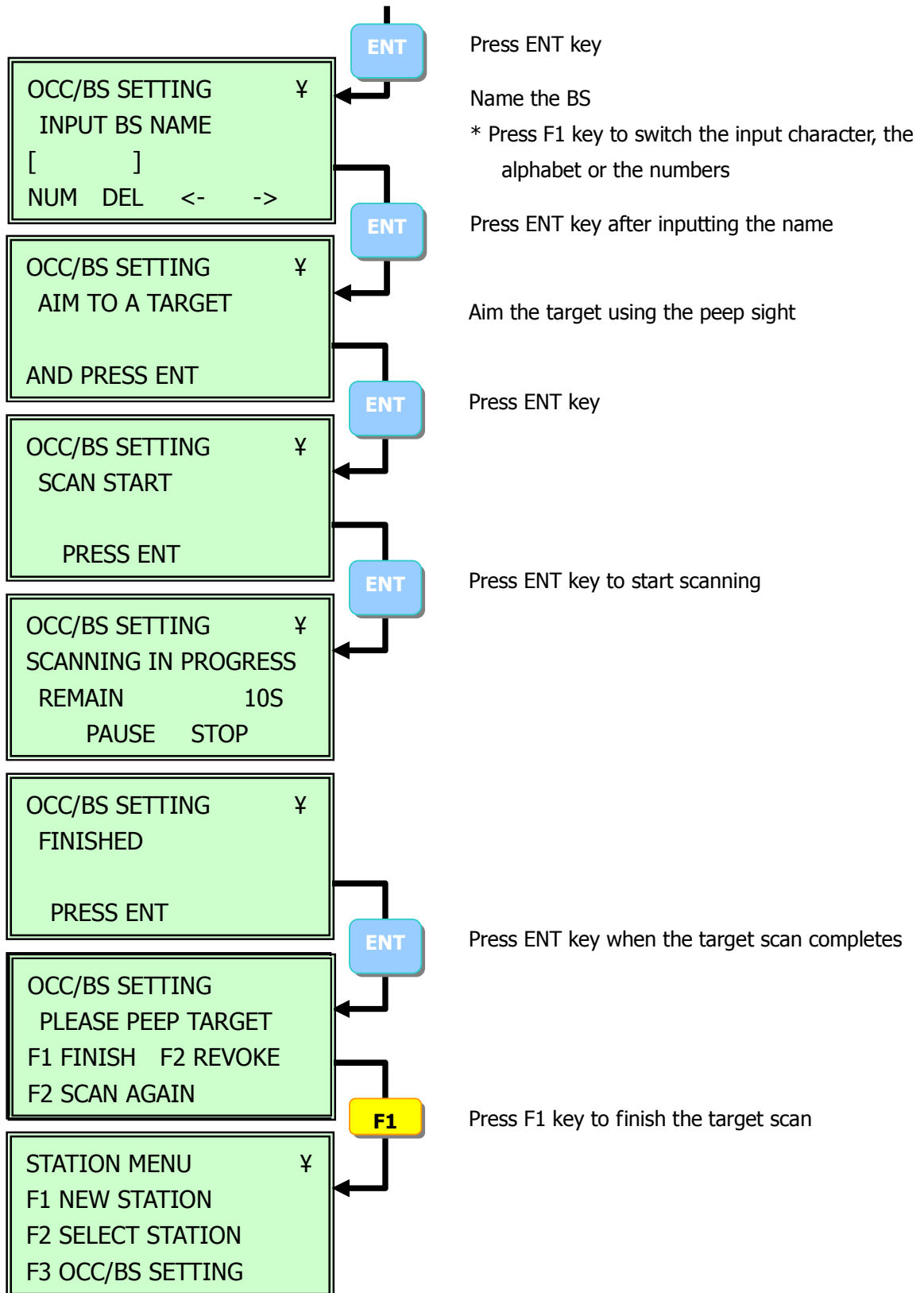

4-2. Target Scan by the Tie Point Method

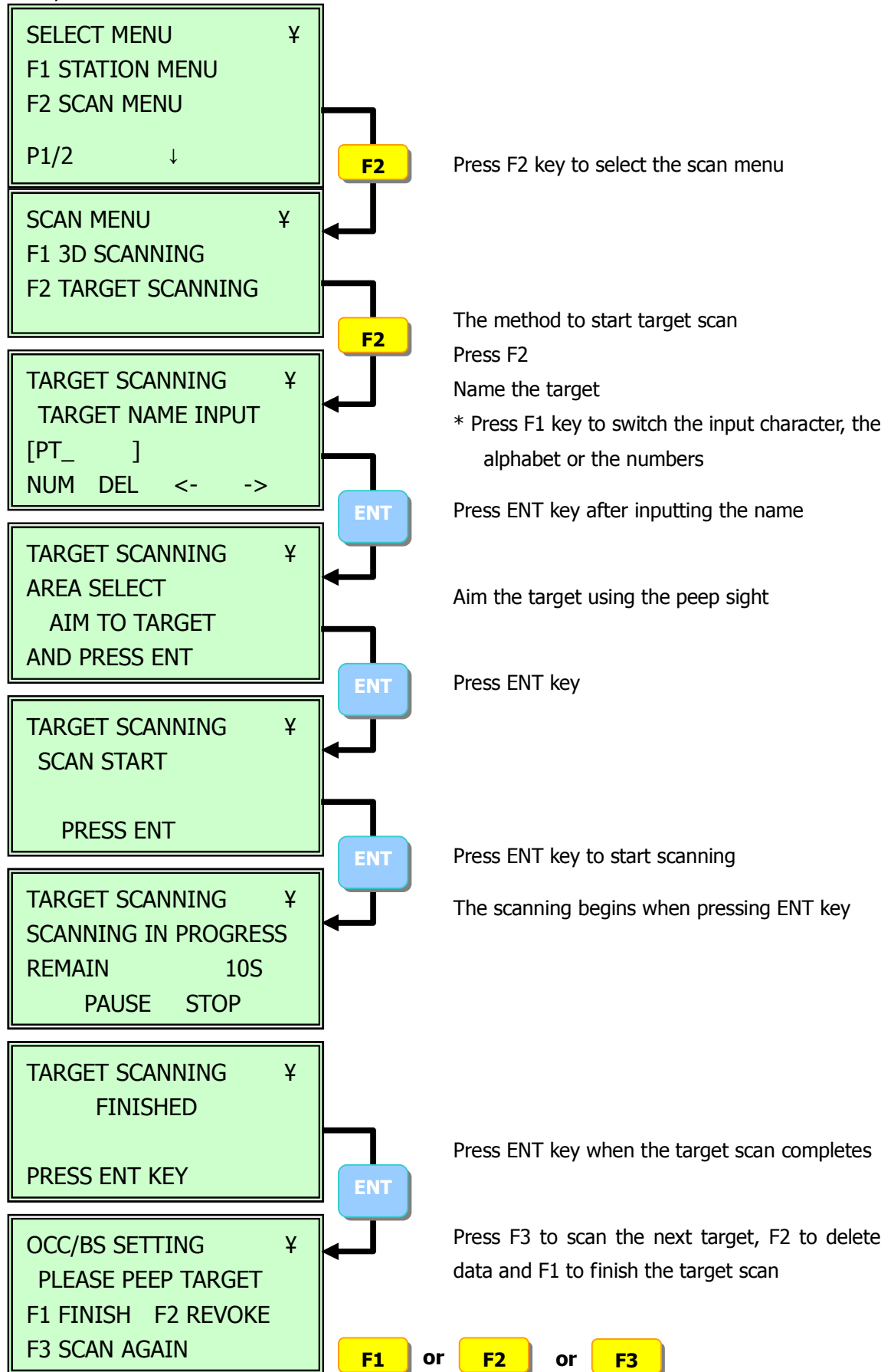

5. Scanning

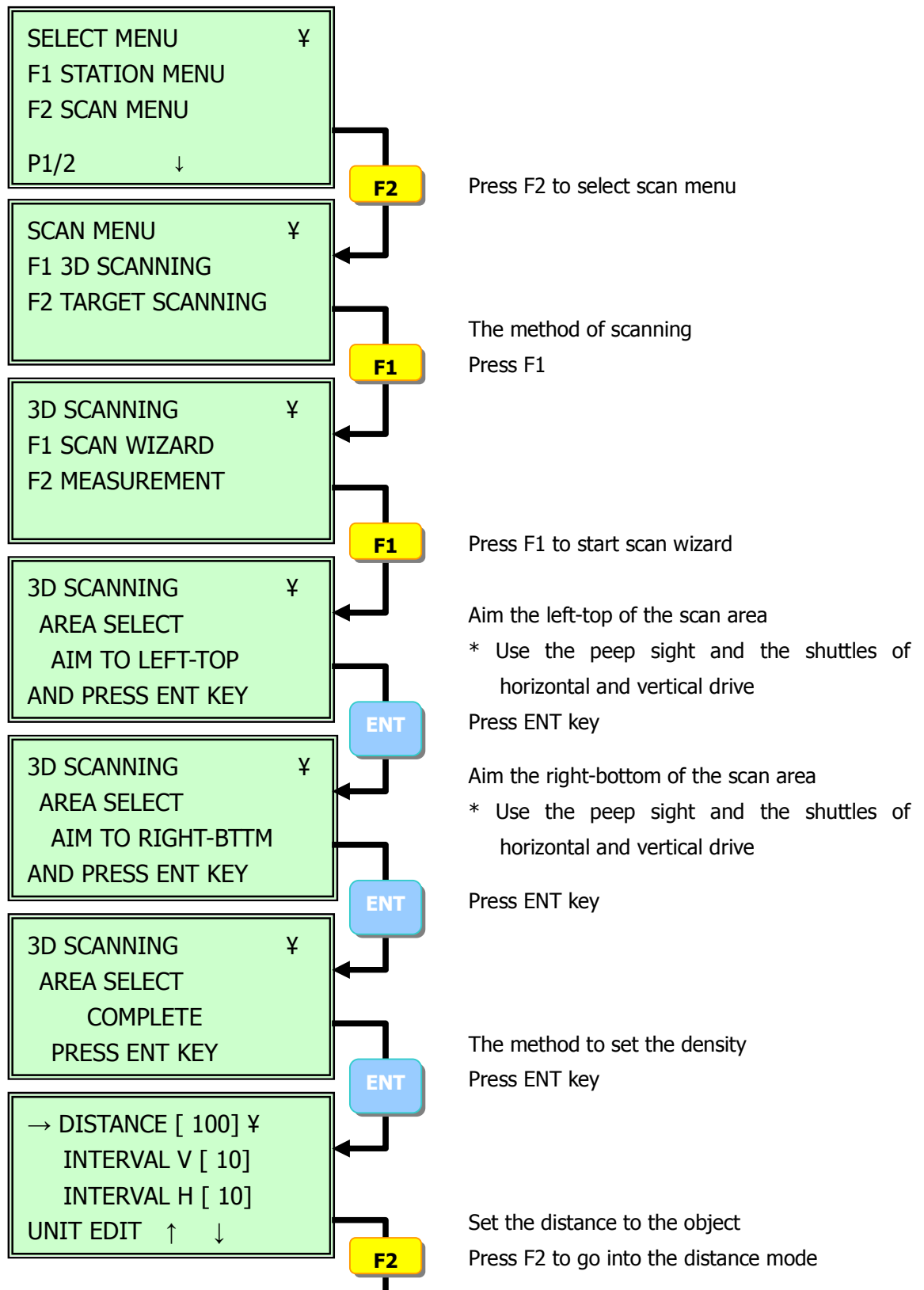

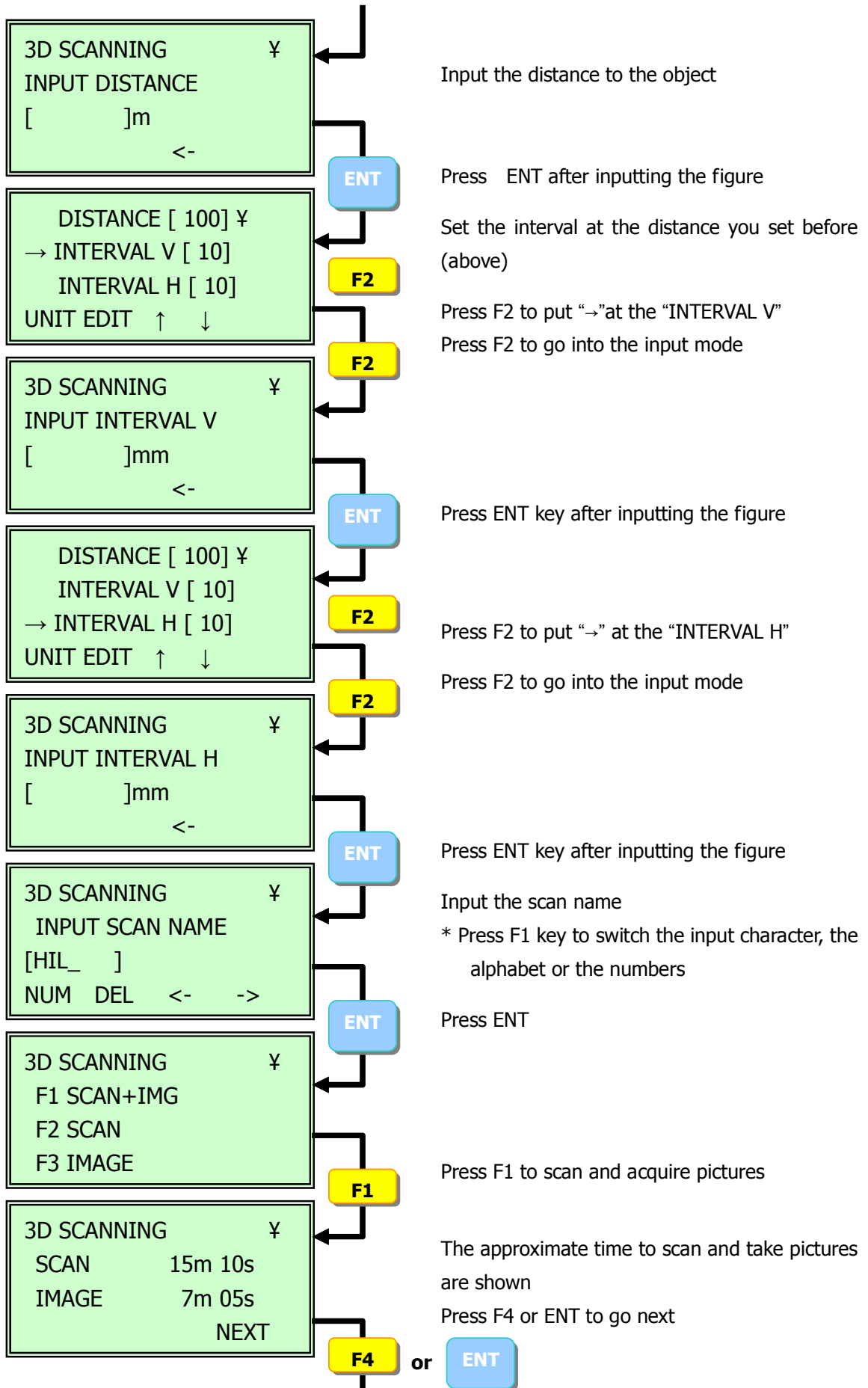

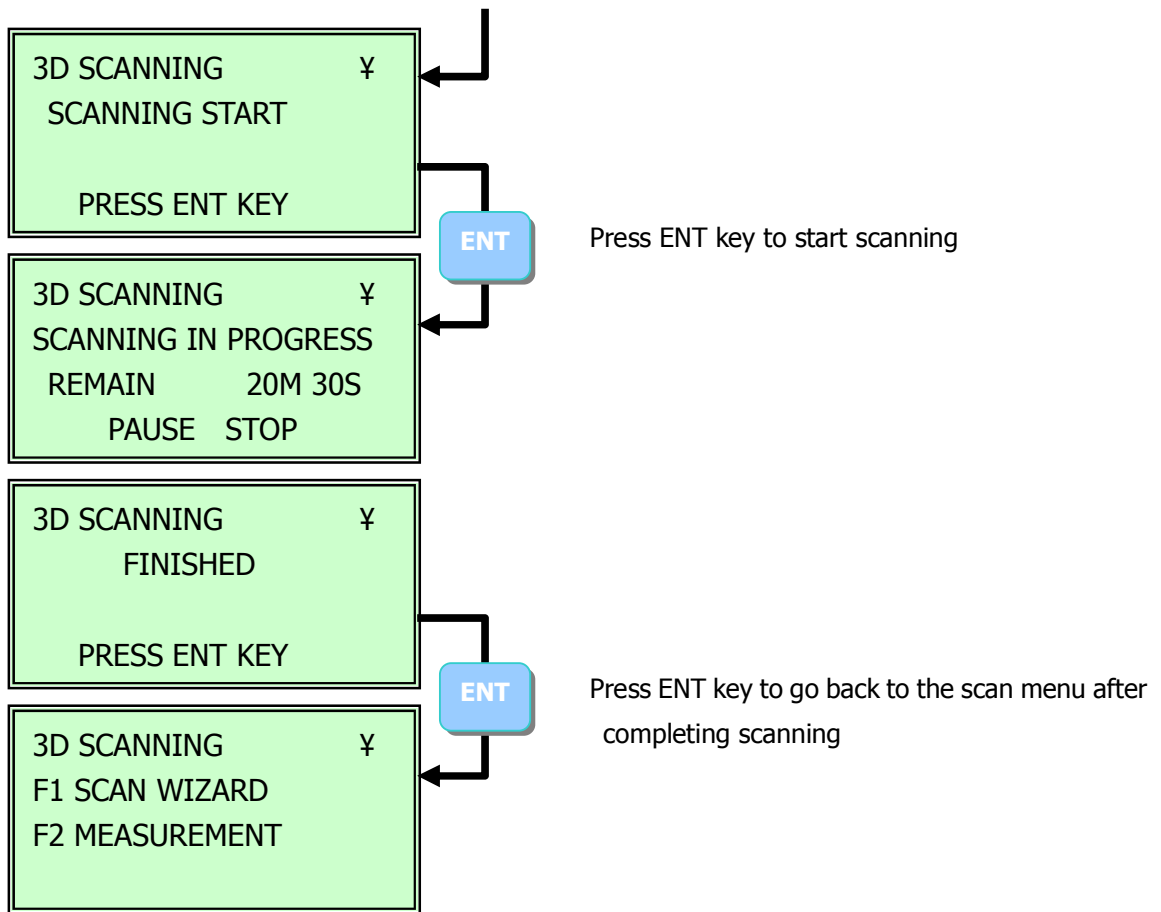

6.How to finish



Press the power button long to switch off